

pipa™ urbn

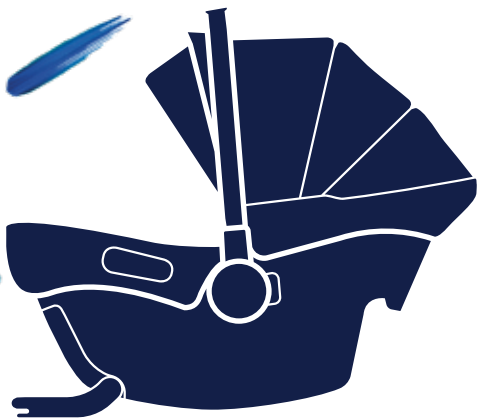

nuna®

Thank you!

You've just purchased a Nuna product, and you can be sure that your child is getting the best there is. Our products are expertly engineered for safety, with luxury fabrics and sophisticated style.

Whatever made you fall in love with Nuna, rest assured your adventures with your little one will be easier from now on, freeing you to enjoy more happy family moments together.

Easy Installation

Our products are designed to make your life easier, so installing this child restraint doesn't require outside assistance. While we encourage the use of Certified Child Passenger Safety Technicians to ensure you have installed the seat correctly, you can install the child restraint in your vehicle without these professionals by carefully reading and following these instructions.



Contents

About PIPA™ urbn

| | |
|-----------------------------------|----|
| Product Information | 4 |
| Product Registration | 4 |
| Recall Information | 4 |
| Warranty | 5 |
| Contact | 5 |
| Child Usage Requirements | 6 |
| Warnings | 6 |
| Car Seat Use after a Crash | 11 |
| Vehicle Compatibility | 12 |
| PIPA™ urbn Parts List | 16 |

Using PIPA™ urbn

| | |
|---|----|
| Product Overview | 18 |
| Product Use | 32 |
| Installation | 40 |
| Installation Using Rigid Lower Anchors | 40 |
| Using Vehicle Lap/Shoulder Belt | 46 |
| Installation in an Aircraft | 52 |
| Installation on a Stroller | 52 |
| Accessories | 54 |
| Seat Pad Removal | 56 |
| Cleaning and Maintenance | 58 |

**IMPORTANT!
KEEP THESE
INSTRUCTIONS
FOR FUTURE
REFERENCE:
READ CAREFULLY**

Product Information

Model Number: _____

Manufactured in (date): _____

Product Registration

Please fill in the above information. The model number and the manufactured in date are located on a label on the bottom of your child restraint. Fill out the prepaid registration postcard attached to the seat pad and mail it today.

Child restraints could be recalled for safety reasons. You must register this restraint to be reached in a recall. Send your name, address, e-mail address if available and the restraint's model number and manufacturing date to:

Nuna Baby Essentials Inc.
70 Thousand Oaks Blvd.
Morgantown, PA 19543

or call 1.855.NUNA.USA

Recall Information

For recall information, call the U.S. Government's Vehicle Safety Hotline at: 1.888.327.4236 (TTY: 1.800.424.9153) or go to <http://www.NHTSA.gov>

Warranty

We have purposely designed our high-quality products so that they can grow with both your child and your family. Because we stand by our product, our gear is covered by a custom warranty per product, starting from the day it was purchased. Please have the proof of purchase, model number and manufactured in date available when you contact us.

For warranty information, please visit: www.nunababy.com/warranty

Contact

For replacement parts, service, or additional warranty questions, please contact our customer service department.

In the USA:
infousa@nunababy.com
www.nunababy.com
1.855.NUNA.USA

Child Usage Requirements

This child restraint is suitable for use with children who meet the following requirements:

Weight: 4 to 22 lbs (1.8 to 10 kg)

Height: less than 29 inches (74 cm)

It is recommended to keep your child rear facing as long as possible, until at least 2 years old.

⚠️ WARNING

DEATH OR SERIOUS INJURY can occur if you fail to follow the warnings, instructions and labels on the child restraint.

A child's safety is your responsibility. **NEVER** leave your child unattended.

Read all instructions before use of this child restraint or installation in a vehicle. In addition, read the vehicle owner's manual for information on child restraint installation.

Store the instruction manual in the pocket located within the seat pad.

Register your child restraint with the manufacturer.

Secure this child restraint with the vehicle's child restraint anchorage system if available, or with a vehicle belt.

This child restraint can **ONLY** be used in a rear facing position when using in a vehicle. The child restraint cannot be properly secured in a forward facing position, and will be unsafe. Use only with children who weigh between 4 and 22 pounds (1.8 and 10 kg) and whose height is 29 inches (74 cm) or less. Exceeding these height and weight limits is unsafe.

Cover the child restraint when your vehicle is parked in sunlight. Parts of a child restraint can become very hot if left in the sun, and can burn a child's skin. Check for hot parts before putting your child in the child restraint.

NEVER use a car seat that has been involved in a moderate to severe crash. **See page 11** to learn what is classified as a moderate to severe crash.

Snugly adjust the belts provided with this child restraint around your child.

If straps are not snugly adjusted, child may be ejected from seat in the event of an accident.

A snug strap should not allow any slack. It lies in a relatively straight line without sagging. It does not press on the child's flesh or push the child's body into an unnatural position.

EXPIRATION DATE Check the label on the underside of the seat for expiration date information.

FALL HAZARD Child's activity can move carrier. **NEVER** place carrier on counter tops, tables, or any other elevated surface. Always stay within arm's reach whenever carrier is not on floor/ground. Be sure handle locks into position before lifting carrier.

The carrier can fall from a shopping cart. **DO NOT** use on a shopping cart.



STRANGULATION HAZARD

Children have strangled in loose or partially buckled harness straps. Fully restrain the child even when carrier is used outside the vehicle.

SUFFOCATION HAZARD

Infant carrier can roll over on soft surfaces and suffocate child. Never place carrier on beds, sofas, or other soft surfaces.

DO NOT allow anyone who has not read the instruction manual to install or use this child restraint.

DO NOT allow child restraint to contact the vehicle interior (side of car door or seat in front).

DO NOT use child restraint if it has frayed or cut harness straps, or is damaged in any way. To find out if damaged parts are replaceable, call 1-855-NUNA-USA.

NEVER modify any part of the child restraint.

DO NOT attempt to use this carrier with a base.



DO NOT use any products or accessories with this child restraint unless they are approved by Nuna for use with this child restraint. Doing so may be unsafe and may void the warranty.

DO NOT leave child restraint in vehicle when uninstalled, even when unoccupied. In a crash, it could become a projectile and injure other vehicle occupants.

NEVER use clothing or blankets that interfere with providing a properly tightened harness. An unsecured or improperly harnessed child can come out of the restraint during a crash. Place blankets over child **AFTER** harness has been properly tightened.

Only use with Nuna strollers or appropriate Nuna adapters designed for use with other strollers.

Car Seat Use after a Crash

The National Highway Traffic Safety Administration (NHTSA) recommends that car seats be replaced following a moderate or severe crash. Car seats do not automatically need to be replaced following a minor crash.

What defines a minor crash?

A minor crash is one in which **ALL** of the following apply:

- The vehicle was able to be driven away from the crash site.
- The vehicle door nearest the car seat was not damaged.
- None of the passengers in the vehicle sustained any injuries in the crash.
- If the vehicle has air bags, none of the air bags deployed during the crash; and
- There is no visible damage to the car seat.

NEVER use a car seat that has been involved in a moderate to severe crash. Contact Nuna with questions or concerns about your seat.

Information from nhtsa.gov

Vehicle Compatibility

You **MUST** read and understand **ALL** child restraint related instructions and warnings in your vehicle owner's manual to correctly and safely use this child restraint in your vehicle.

This child restraint can **ONLY** be installed on vehicle seats that face forward. **DO NOT** install in seats that face to the sides or rear of the vehicle.

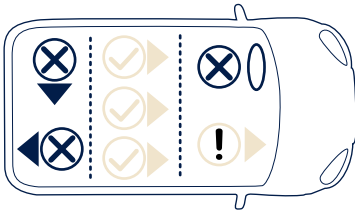

NEVER install this child restraint rear facing in a vehicle seating position with a frontal air bag unless it is turned off. Airbags inflate with

great force and can cause severe injury to a child's neck and spine. If your vehicle is equipped with

passenger side air bags, check your vehicle owner's manual for child restraint installation instructions.

According to accident statistics, children are safer when properly restrained in the rear seating positions than in the front seating positions.

Vehicle Belt Use

Refer to your vehicle owner's manual to determine if the belts in your vehicle lock by switching the seat belt's retractor **OR** if they have a locking latch plate that locks the vehicle's seat belt so they will hold the child restraint tightly without loosening.

(Vehicle Belt Use continued on the next page)

These vehicle belts **CANNOT BE USED** with your child restraint. Install with lower anchors instead.

1 - Motorized Belts (Automatic)

These should not be used unless the shoulder belt can be removed, the lap belt is locked and use is allowed by the vehicle manufacturer.

2 - Dual Retractor Belts

If allowed by the manufacturer, the lap belt only may be used to secure the child restraint in accordance with this manual and the vehicle owner's manual.

3 - Non-Locking (ELR) Lap Belts

This belt **ONLY** locks in a crash or sudden stop and should only be used with a belt shortening clip. Contact your vehicle manufacturer if needed.

4 - Airbag/Inflatable Belts

This belt cannot be used to install this child restraint.

5 - Door Mounted Belts

This belt cannot be used to install this child restraint.

6 - Lap Belts forward of Seat Bight

This belt (is forward of where the seat back and seat bottom meet) cannot be used to install this child restraint.

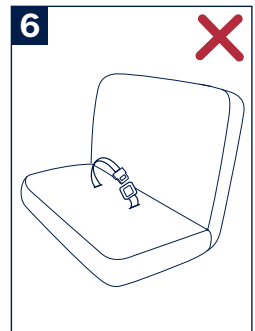
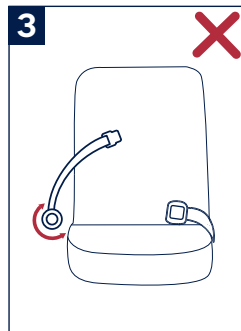
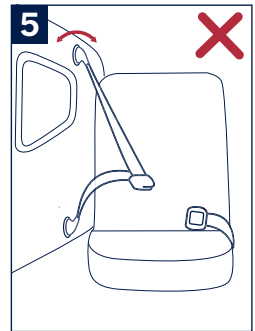
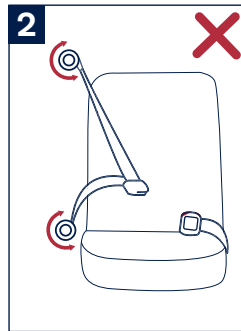
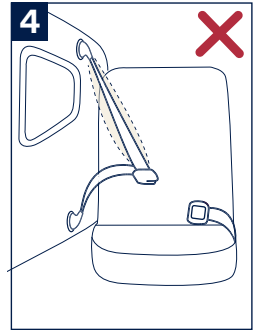

PIPA™ urb n Parts List

Make sure all parts are available before assembly. If any part is missing, please contact Nuna (see page 5 for information). No tools are required for assembly.

- 1 Rigid Lower Anchor Guides
- 2 Head Support
- 3 Seat Pad
- 4 Shoulder Pads
- 5 Chest Clip
- 6 Body Support
- 7 Low Birth Weight Pillow (inside Body Support)
- 8 Buckle
- 9 Harness Adjustment Button
- 10 Harness Adjustment Strap
- 11 Crotch Pad
- 12 Rigid Lower Anchor
- 13 Lap Belt Guide
- 14 Magnetic Buckle Holder
- 15 Handle Adjustment Button
- 16 Post Adapter Release Button
- 17 Instruction Manual Pocket
- 18 Handle
- 19 Canopy Drape Zipper
- 20 Canopy Window
- 21 Rigid Lower Anchor & Stroller Release
- 22 Shoulder Belt Guide
- 23 Shoulder Harness Straps
- 24 Harness Splitter Plate
- 25 Canopy
- 26 Canopy Mount
- 27 Rain Cover*

*Included on some models; available for separate purchase

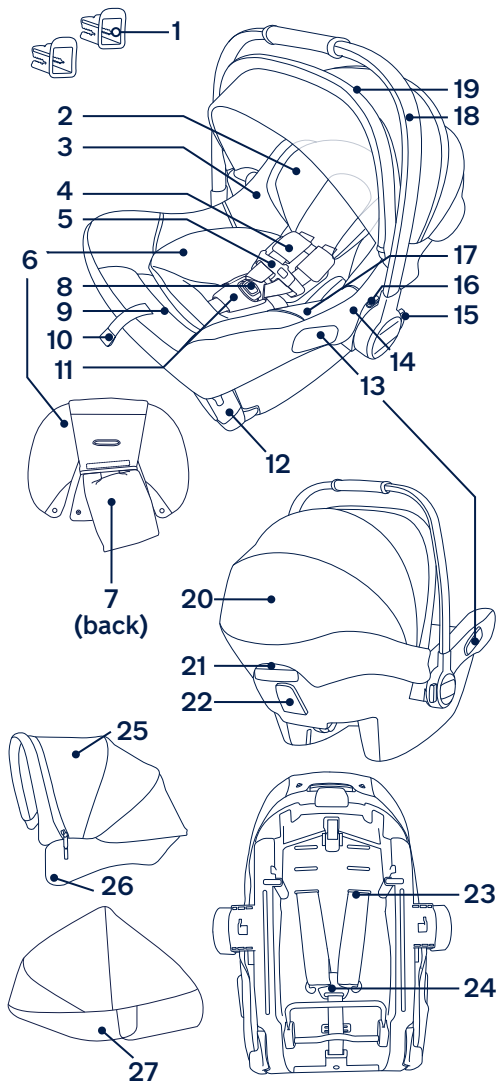

Product Overview

Magnetic Buckle Holders

- 1 - Loosen and unbuckle harness. Place the buckle tongues against the magnetic area on the side of the child restraint so that the tongues are held in place.

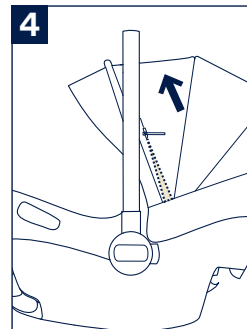
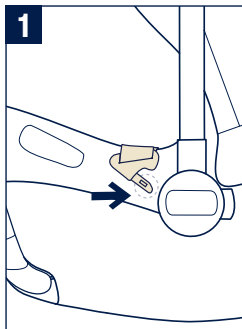

Canopy

- 2 - To assemble the canopy, slide the canopy mounts into the openings in the seat shell. Check that the canopy is secure by pulling up on the canopy mount.
 - 3 - Fasten the snaps on the back of the canopy to the seat soft goods on both sides.
 - 4 - Unzip the zipper behind the front canopy bow.
 - 5 - Pull the canopy drape out of the compartment and attach the canopy drape to the magnets on each corner at the front of the carrier.
- (continued on the next page)*

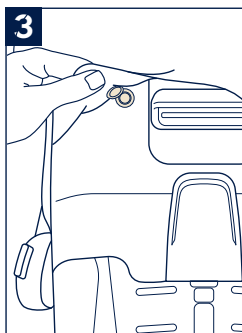
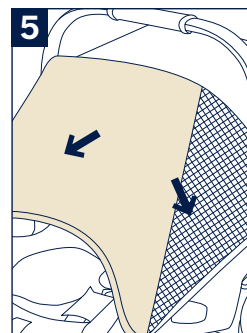
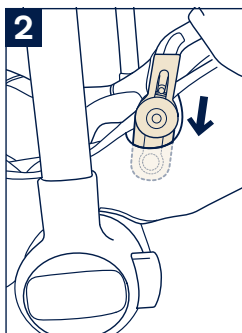

Canopy (continued)

- 1 - The canopy window can be opened for ventilation.
- 2 - To remove the canopy, first undo the snaps on the back of the canopy soft goods.
- 3 - Undo the snaps on the seat soft goods near the handle.
- 4 - Push the release button in the center of the canopy mounts and pull the canopy mounts out of the seat shell to remove.

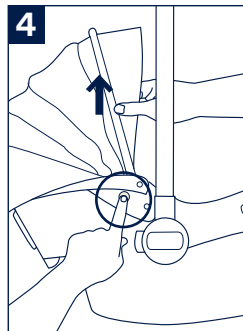
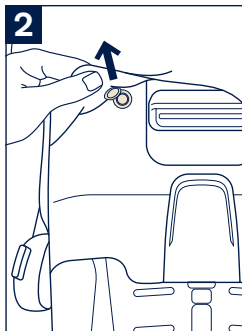
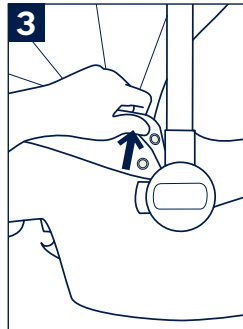
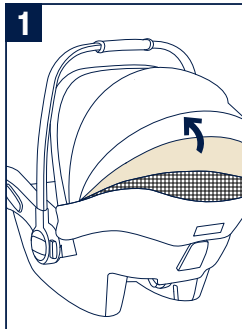

Shoulder Pads

- 1 - Shoulder pads are removable.
Unbutton the two snaps to remove.

Crotch Pad

- 2 - Crotch pad is removable.
To remove, slide the plastic tab out from behind the buckle.
- 3 - Pull the crotch pad off of the buckle.

Head and Body Support

The head and body supports can be used as necessary, to provide a snug fit for small babies.

The smaller head support piece can be removed when your child has outgrown it.

! The head support straps cannot go through the same slots as the harness and should only be used in the top two harness slot positions.

- 4 - To remove the head support, unfasten the hook and loop ends behind the seat fabric.
- 5 - Pull the head support straps through the harness slots.
(continued on the next page)

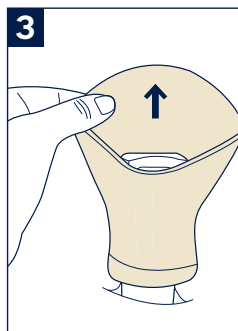
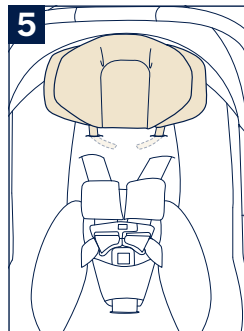
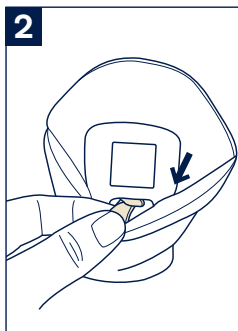
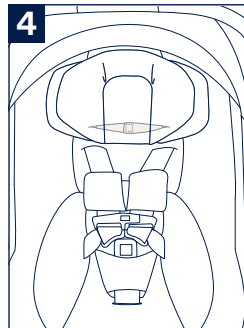
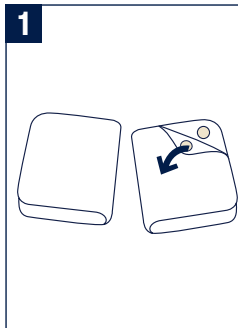

Head and Body Support *(continued)*

The head and body supports can be used as necessary, to provide a snug fit for small babies.

- 6 - To remove the body support, unbuckle the harness and route the buckle and crotch belt through the bottom slot of the body support.

! The body support can be used for smaller babies, but **MUST** be removed once the child reaches 11 lb.

Low Birth Weight Pillow

- 7 - The low birth weight pillow inside the body support (highlighted) can be used for even smaller babies, but it must be removed once the child reaches 11 lb.
- 8 - To remove the low birth weight pillow, slide it out of the pocket on the body support.

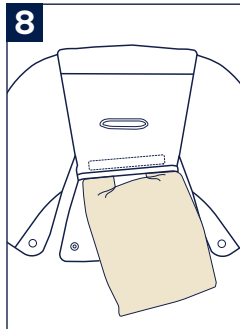
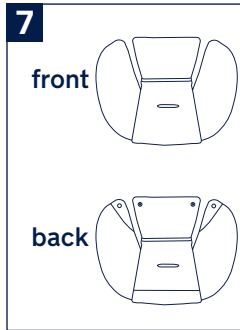
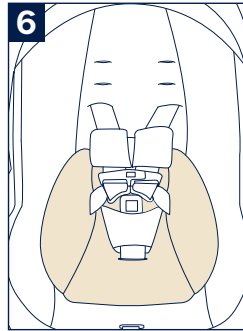

Shoulder Belts

- 1 - Tighten harness to fit snugly on child's shoulders. It is snug if you cannot pinch a fold in the strap horizontally.
- 2 - Harness straps must be at or just below shoulders.
- 3 - To adjust shoulder harness height, remove child and loosen harness.
- 4 - Then turn child restraint over and remove one harness loop from metal splitter plate.
- 5 - Pull loose end of harness out through slots and place in correct slot.

(continued on the next page)

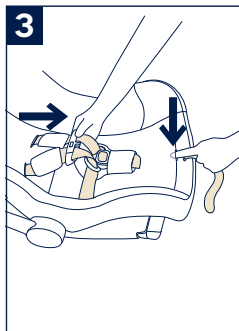
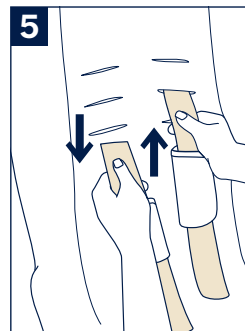
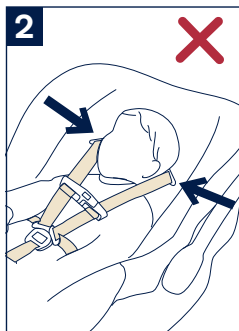
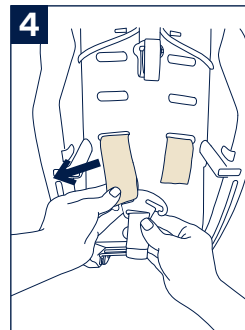
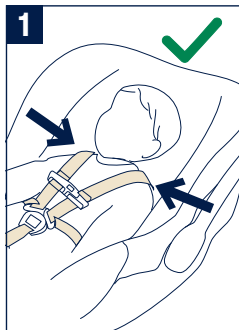

Shoulder Belts *(continued)*

- 1 - Re-attach harness loop to splitter plate.
- 2 - **⚠** Do not allow harness to pass over bars. Repeat process for second shoulder harness strap.

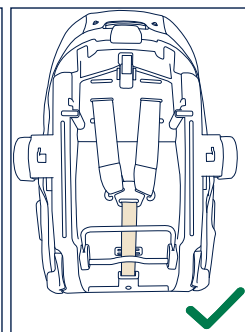
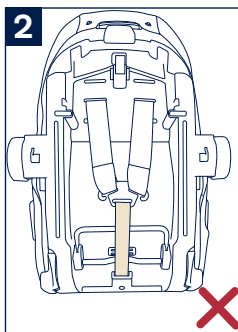
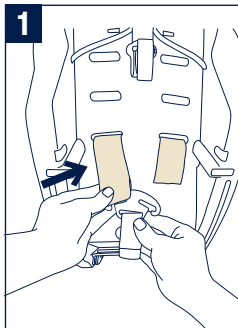

Harness Length Adjustment

- 1 - Loosen the harness by pressing on adjustment button (1) while pulling on the harness straps. (2)

Handle Adjustment

- 2 - The carrier handle can be adjusted to 3 positions.
- 3 - To adjust the handle position, squeeze handle buttons on both sides. (1)

Rotate handle until it clicks into any of the 3 positions. (2)
Handle can be used in vehicle in any locked position.

- ⚠** Be sure handle is locked in the carry position before lifting child restraint by handle. An unlocked handle could move unexpectedly, causing injury to child.

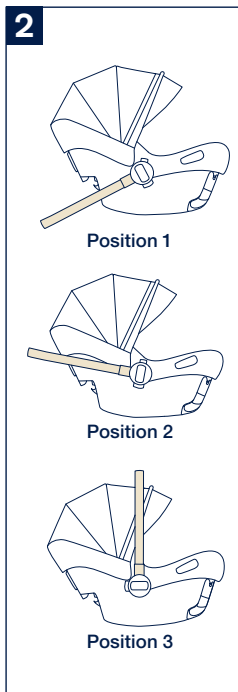
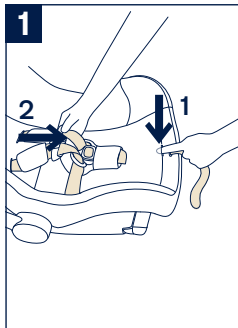

Product Use

- 1 - Top of child's head should be at least 1 inch below top of child restraint.

Securing Child in Child Restraint

- 2 - Loosen harness by pressing on adjustment button **(1)** while pulling on the harness straps. **(2)**
- 3 - Press buckle button. **(1)** Press button to release the halves of the chest clip. **(2)** Separate chest clip and spread harness straps apart. **(3)**
- 4 - Place child in child restraint in seated position. The child should be seated against both the back and bottom of the seat with no gap behind the child. Do not allow child to slouch.

(continued on the next page)

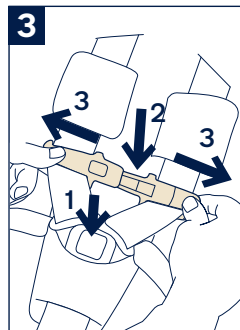
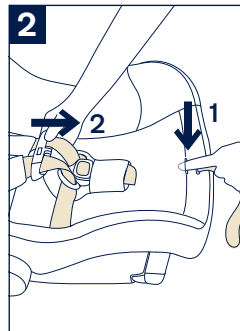
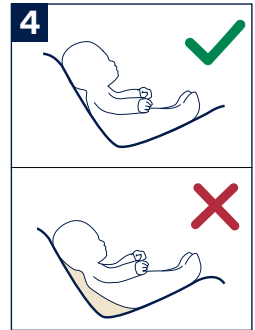
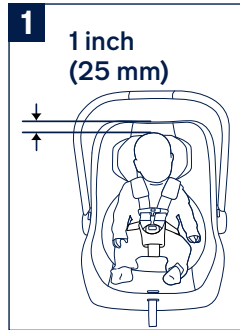

Securing Child in Child Restraint *(continued)*

5 - **⚠** Harness straps must be at or just below child's shoulders to avoid injury. If harness slots need to be moved, see Shoulder Belts section (p.26).

Gently guide child's arms through harness straps. If more harness length is needed, see page 26 for instructions.

(continued on the next page)

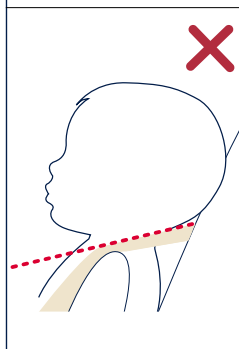
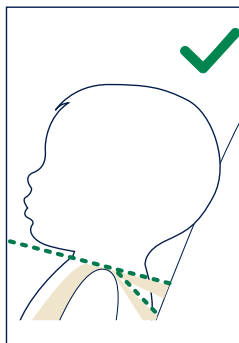
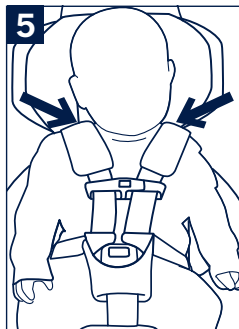

Securing Child in Child Restraint *(continued)*

- 1 - Insert buckle tongues into buckle.
- 2 - Listen for clicks. Pull on buckle to verify it is latched.
- 3 - Snap the chest clip together and temporarily slide towards buckle for tightening of harness.
- 4 - Tighten harness by pulling on the adjustment strap **(1)**. Pull any excess harness webbing through the buckle towards the child's shoulders **(2)** and pull again on the adjustment strap. This may need to be repeated several times for proper fit.

Verify that the harness is snug around the child's waist and shoulders.

- 5 - Position the chest clip at child's armpit level.

(continued on the next page)

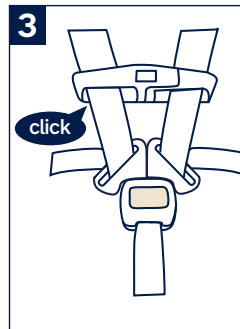
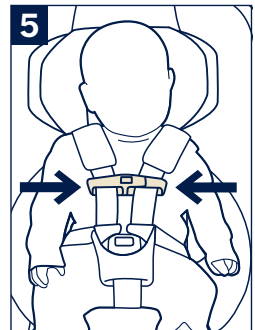
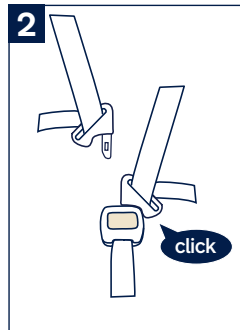
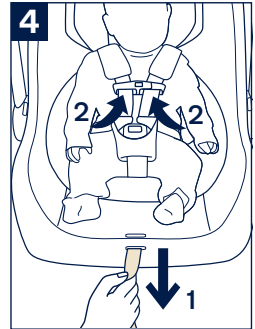
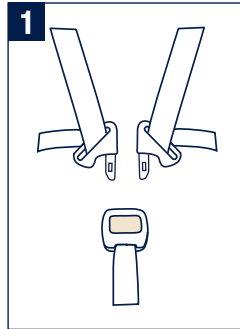

Securing Child in Child Restraint *(continued)*

Make sure that nothing interferes with the harness. Make sure harness is snug around child and lays flat. Serious injury or death could occur to a child that is not secured properly.

If child is not secured properly, child could be ejected in a sudden stop or crash, resulting in serious injury or death.

Check that Child is Secure

- Snugly adjust the belts provided with this child restraint around your child.
- If straps are not snugly adjusted, child may be ejected from seat in the event of an accident.
- A snug strap should not allow any slack. It lies in a relatively straight line without sagging. It does not press on the child's flesh or push the child's body into an unnatural position.
- Harness is snug – A snug harness cannot be pinched horizontally, and should not allow any slack.

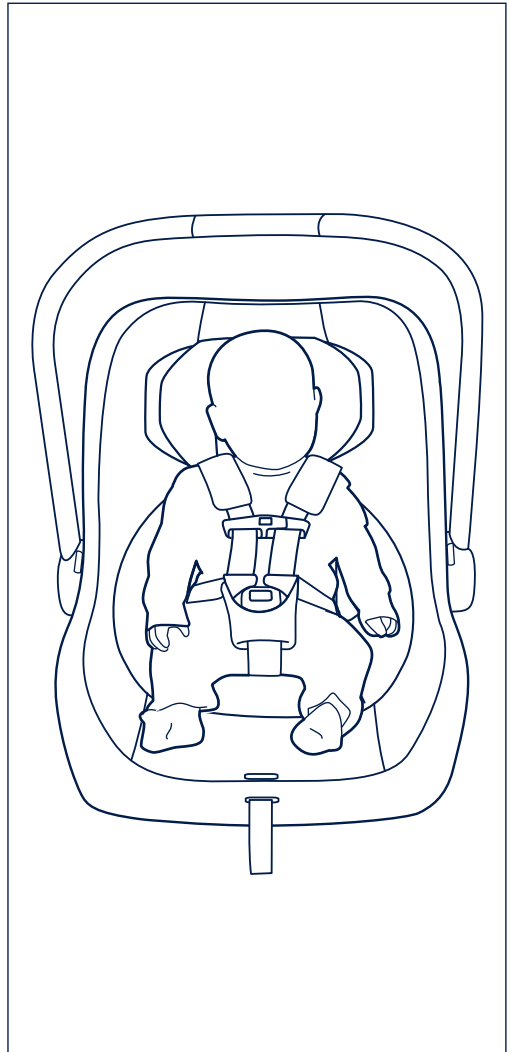

Installation

⚠ If child is not secured properly, child could be ejected in a sudden stop or crash, resulting in serious injury or death.

Installation Using Rigid Lower Anchors

- 1 - To help with installation of child restraint, install rigid lower anchor guides on vehicle  lower anchor bars.
- 2 - Rotate rigid lower anchors down. This also lowers the recline bar, which helps position the child restraint at the correct angle for installation.
- 3 - Position child restraint in a forward facing vehicle seat.
(continued on the next page)

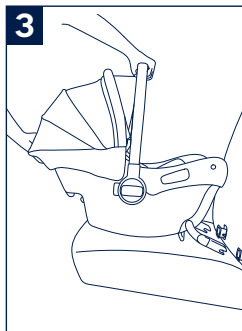
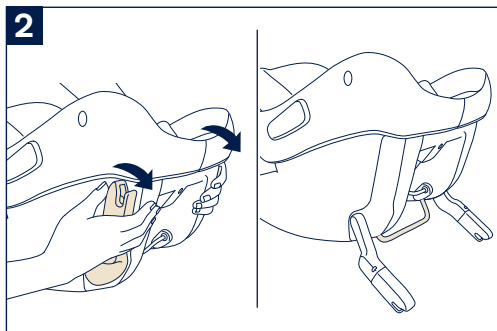
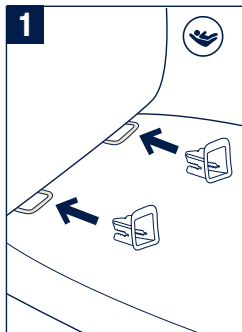

Installation Using Rigid Lower Anchors *(continued)*

- 1 - Guide rigid lower anchors onto vehicle lower anchor bars. Push both rigid lower anchors firmly onto vehicle lower anchor bars until they click into position.
 - 2 - Check installation of rigid lower anchors on child restraint **AND** seeing that green is indicated on the connectors. If child restraint moves freely side to side, or the indicator on the rigid lower anchor is red. Retry to secure rigid lower anchors to vehicle lower anchors and re-check.
- !** The rigid lower anchors must be attached onto the vehicle lower anchor bars, and the indicator must be green.
- 3 - Make sure the level line on the restraint label is as level as possible with the ground.
(continued on the next page)

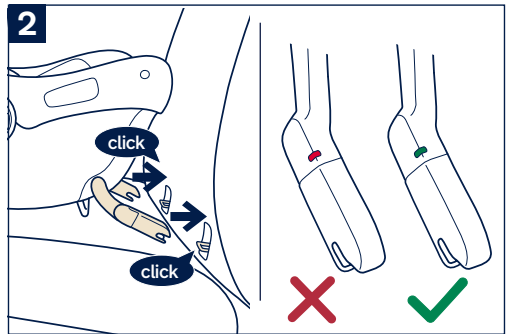
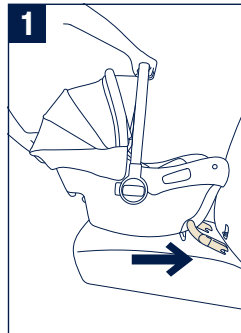

Check the Installation

- Make sure the rigid lower anchors are properly connected by pulling firmly on the child restraint.
- A gap between the restraint and the vehicle seatback may be visible.

It is acceptable to install with both rigid lower anchors and the vehicle belt.

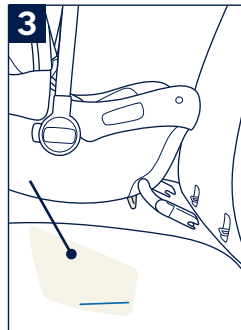

Installation Using Rigid Lower Anchors *(continued)*

- 1 - To remove the child restraint, squeeze the rigid lower anchor release on the back of child restraint and pull child restraint away from vehicle lower anchor bars.
- 2 - Rotate rigid lower anchor connectors up to storage position, and click them into place. Remove child restraint from the vehicle.

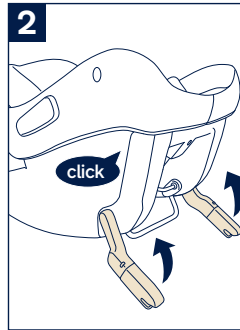
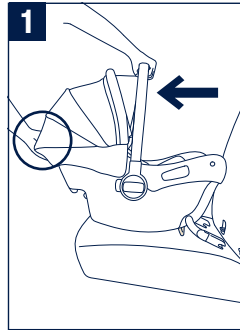

Using Vehicle Lap/ Shoulder Belt

⚠ Only install in a forward facing vehicle seat.

- 1 - Position child restraint so that child is facing the rear of the vehicle.
- 2 - Option 1 (Preferred): Route the vehicle **lap belt** under both lap belt guides. Then route the shoulder belt around the back of the child restraint passing through the blue **shoulder belt** guide.

Option 2: Route the vehicle **lap belt** under both lap belt guides and buckle the vehicle belt. Allow **shoulder belt** to lay against vehicle seat back as shown.

- 3 - Adjust the angle of the child restraint. A rolled up towel or foam pool noodle may be used to adjust the amount of recline.
- 4 - Angle is correct when blue line on child restraint (located on the label on the side of the child restraint) is level with ground.
- 5 - Tighten vehicle belt while pushing child restraint firmly into vehicle seat. Remove all vehicle belt slack around belt guides and feed belt into vehicle belt retractor. **Lock** or switch vehicle belt to **locked mode**. Refer to vehicle owner's manual for instructions. If you cannot lock the vehicle belt, you must use a locking clip (p.52).

See p. 50 for final belt install steps.

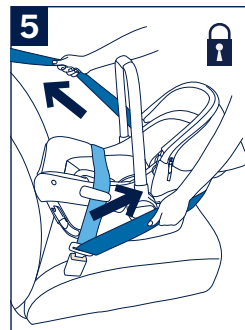
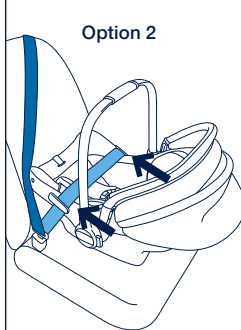
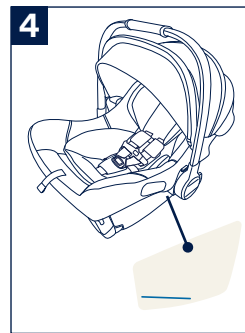
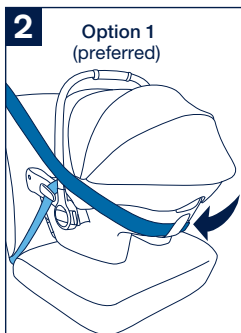
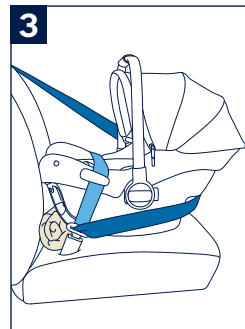
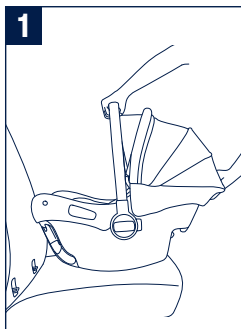

Using Lap Belt Only

- ⚠** Only install in a forward facing vehicle seat.
- 1 - Position child restraint so that child is facing the rear of the vehicle.
 - 2 - If your vehicle does not have a shoulder belt, the lap belt only can be used. Route the belt across the belt guides, as shown.
 - 3 - Adjust the angle of the child restraint. A rolled up towel or foam pool noodle may be used to adjust the amount of recline.
 - 4 - Angle is correct when blue line on child restraint (located on the label on the side of the child restraint) is level with ground.
 - 5 - Tighten vehicle belt while pushing child restraint firmly into vehicle seat. Remove all vehicle belt slack around belt guides and feed belt into vehicle belt retractor. **LOCK** the vehicle belt. Refer to vehicle owner's manual for instructions. If you cannot lock the vehicle belt, you must use a locking clip (p.52).

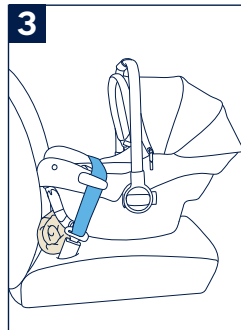
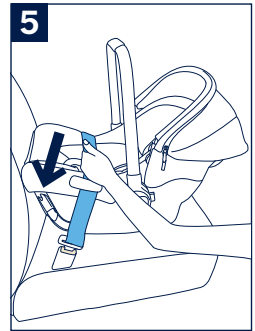
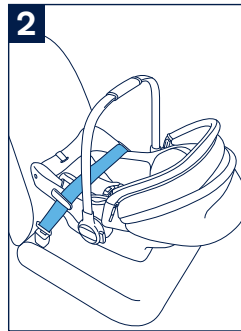
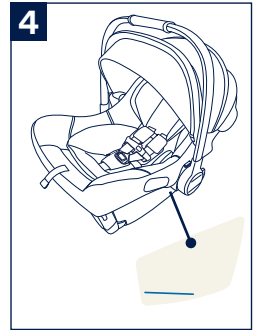
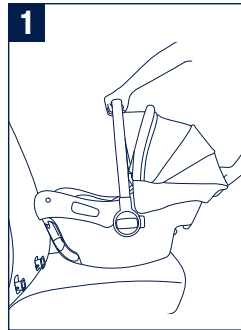

See p. 50 for final belt install steps.

Check Vehicle Belt Install

- 1 - Make sure the vehicle belt is as tight as possible around the restraint, making sure the belt is not loose or twisted.

Check the Installation

- Blue line must be level with ground.
- Vehicle belt must be buckled, tight and must stay locked.
- Child restraint should be stable and not move side to side more than 1 inch at belt path.

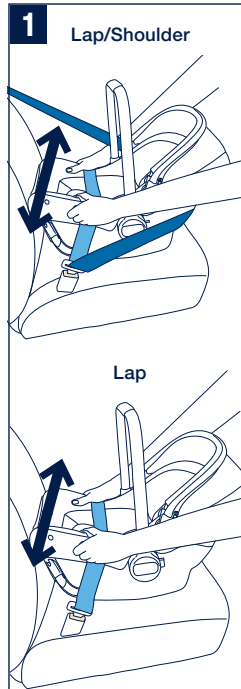

Locking Clip

If you determine that you need to use a locking clip, please contact Nuna Customer Service.

By phone: 1.855.NUNA.USA

By email: infousa@nunababy.com

Installation in an Aircraft

Position child restraint so that child is facing the aircraft seat back.

- 1 - Route the aircraft lap belt under both lap belt guides. Then buckle the aircraft lap belt.
- 2 - Adjust the angle of the child restraint. The angle is correct when the blue line is level with the floor of the aircraft (1).

Tighten the aircraft belt while pushing the child restraint firmly into the seat. Making sure to remove any slack through belt guides.

This child restraint is certified for use in commercial aircraft. Be sure to contact your airline prior to travel to discuss their use policy.

Installation on a Stroller

This infant carrier can easily attach to Nuna strollers* (see Accessories, p.54). Adapters are sold separately. Visit nunababy.com for information.

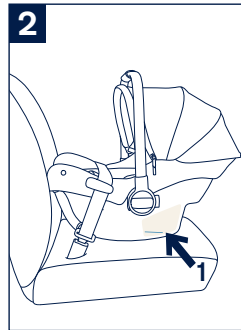
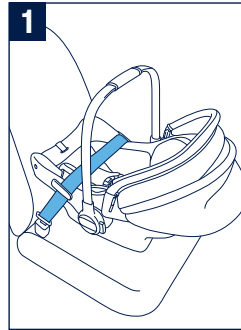

*Attaches to Nuna TAVO™ series and TRVL™ without adapters

Accessories

PIPA series Adapters

The PIPA series can attach to Nuna strollers using adapters*. Instructions are included with the adapters, which are sold separately.

- 1 - Infant Car Seat Ring Adapter
- 2 - Infant Car Seat Post Adapters

Visit nunababy.com for more information.

PIPA urbn Rain Cover

- 3 - Place the rain cover over the child restraint.

⚠ ALWAYS check ventilation when the rain cover is on the child restraint.

NEVER leave the rain cover in place in hot weather with your child in the child restraint.

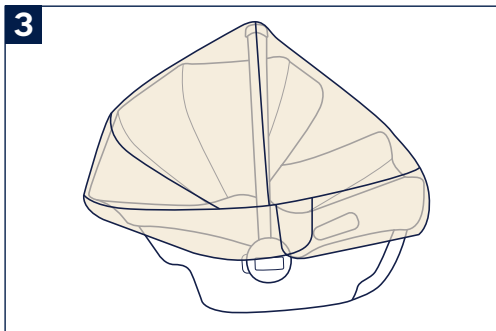
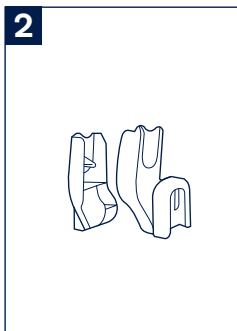
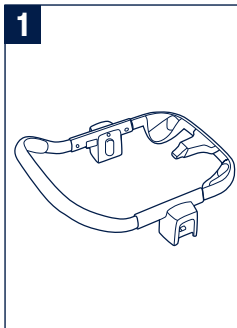

*Attaches to Nuna TAVO™ series and TRVL™ without adapters

Seat Pad Removal

1 - To remove the canopy, undo the snap on the canopy fabric. Press the button in the canopy mount. Also, undo the fabric snap buttons and remove the crotch strap pad. See Product Overview section.

2 - Pull out the fastening pieces underneath the edge of the seat.

The best way to work this area (as some seat pads feel more tight in this area than others) is to pull the fabric towards the front of the seat at one corner. Once you have one corner out, you can easily work the other side out.

3 - Remove the harness from the splitter plate.

4 - Pull the adjuster strap out through the bottom adjuster strap opening.

Re-attach the seat pad following steps 1 through 3 in reverse.

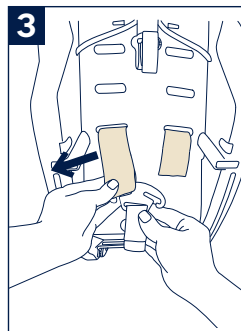
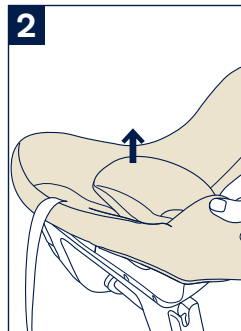
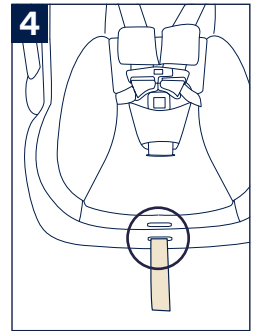
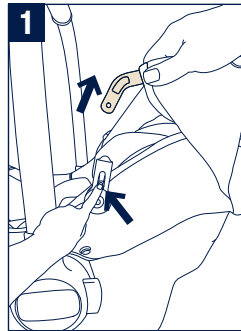

Cleaning and Maintenance

Refer to the care label attached to the soft goods for washing and drying instructions.

DO NOT attempt to remove the foam or tape under the seat pad.

Use only mild detergent, water and a soft cloth to clean the infant carrier shell, handle and harness straps. Air dry.

To clean the buckle: rinse using warm water. **DO NOT** use any soaps, solvents or lubricants. Using anything other than water can cause the buckle to malfunction. Air dry.

Remove the infant carrier from the vehicle seat if not in use for a long period of time. Put the infant carrier in a cool, dry place and somewhere your child can not access it.

It is normal for fabric to color from sunlight and to show wear and tear after a long period of use, even when used normally.

Check regularly if everything functions properly. If any parts are torn, broken, or missing, stop using this product. Contact Nuna for replacement parts.

Nuna Baby Essentials, Inc. Nuna and all associated logos are trademarks.

