



# Inglesina

## COPERNICO

CHILD CAR SEAT

MANUALE ISTRUZIONI	IT
INSTRUCTION MANUAL	EN
MANUEL D'INSTRUCTIONS	FR
BEDIENUNGSANLEITUNG	DE
MANUAL DE INSTRUCCIONES	ES
MANUAL DE INSTRUÇÕES	PT
РУКОВОДСТВО С ИНСТРУКЦИЯМИ	RU
ΕΓΧΕΙΡΙΔΙΟ ΟΔΗΓΙΩΝ	EL
INSTRUKCJA OBSŁUGI	PL

**IMPORTANT - READ THESE  
INSTRUCTIONS CAREFULLY BEFORE  
USE AND KEEP FOR FUTURE  
REFERENCE.**

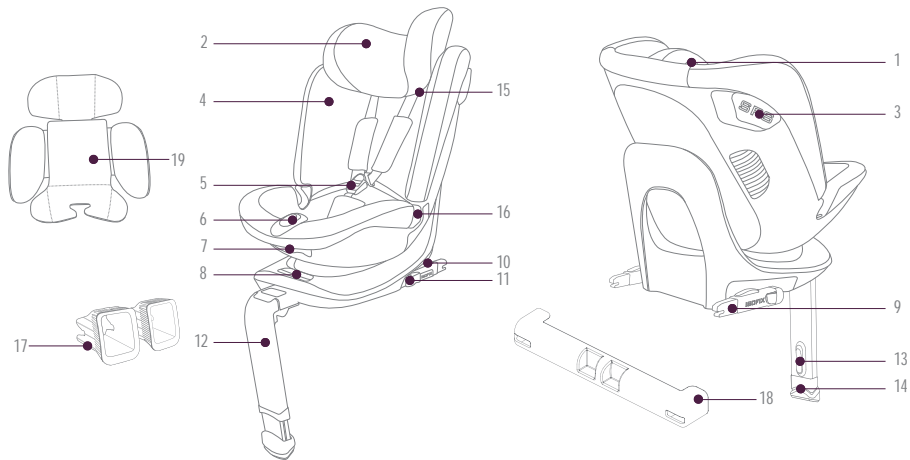

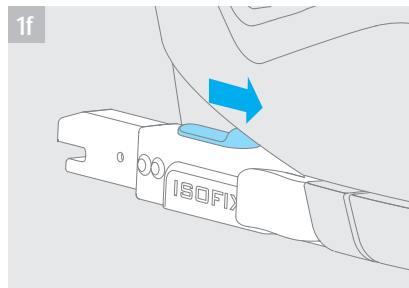
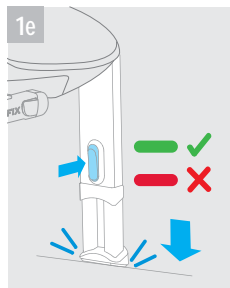
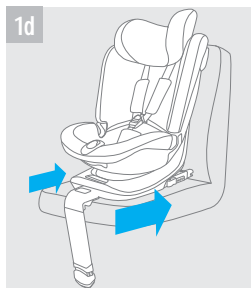
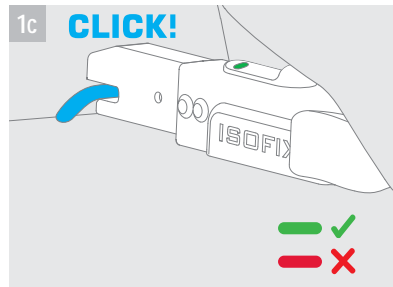
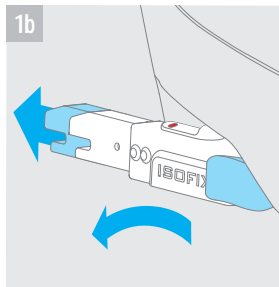
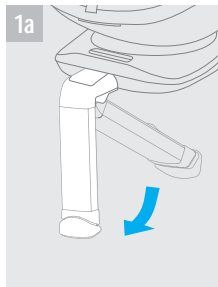

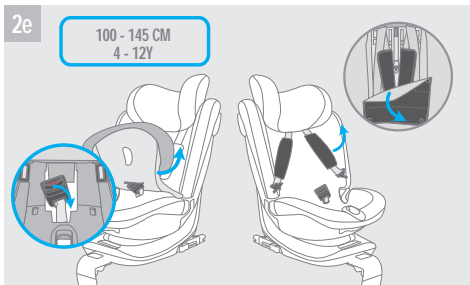
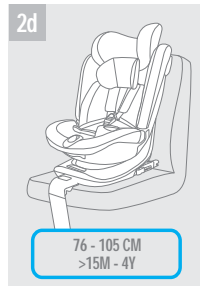
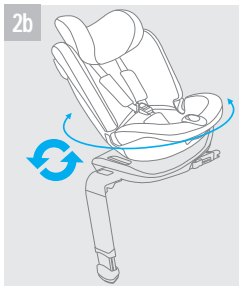

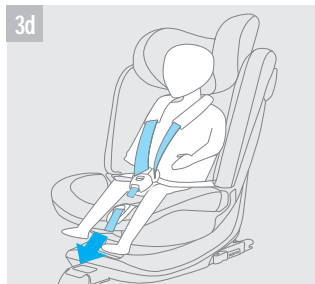
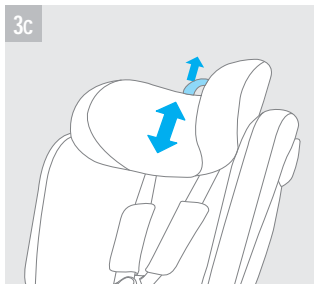
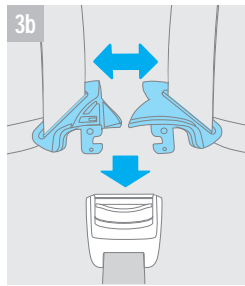
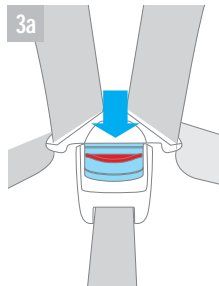
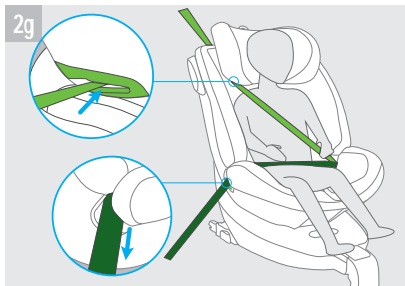

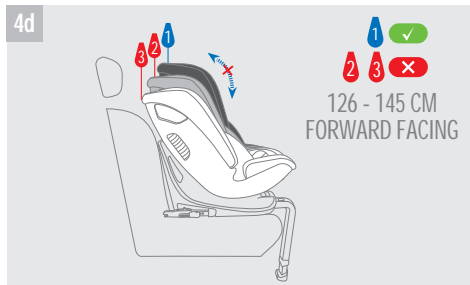
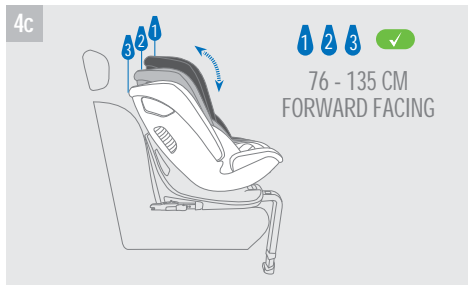
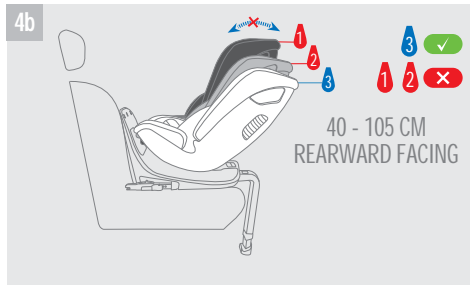
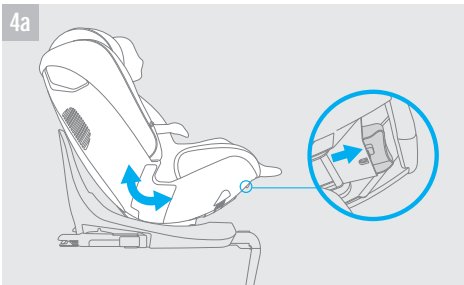

5a

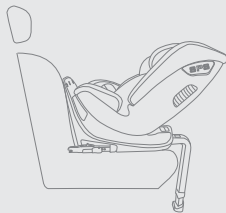

5b

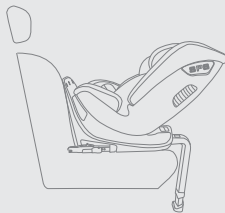

5c



6a

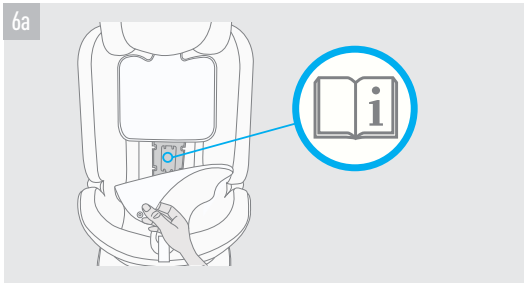



## COPERNICO

40 cm-145 cm / (Birth - 12 years old)



- **Notice:** This is an Enhanced Child Restraint System. It is approved according to UN Regulation No. 129, for use in compatible vehicle seating positions as indicated by vehicle manufacturers in the vehicle user manual. In doubt, consult either the Enhanced Child Restraint System manufacturer or the retailer.
- **IMPORTANT- DO NOT USE FORWARD FACING BEFORE THE CHILD'S AGE EXCEEDS 15 MONTHS.**

## WARNING



• **READ THESE INSTRUCTIONS CAREFULLY BEFORE USE AND KEEP THEM FOR FUTURE REFERENCE. FOR PROPER PROTECTION OF YOUR CHILD, IT IS ESSENTIAL TO USE AND INSTALL THE CHILD CAR SEAT ACCORDING TO THE INSTRUCTIONS GIVEN IN THIS MANUAL.**

- **YOUR CHILD'S SAFETY IS YOUR RESPONSIBILITY.**

**• WARNING! NEVER LEAVE THE CHILD UNATTENDED: IT CAN BE DANGEROUS. PAY UTMOST CARE WHEN USING THE PRODUCT.**

## SAFETY

**• THIS CHILD CAR SEAT DOES NOT GUARANTEE PROTECTION FROM INJURY IN ALL SITUATIONS. HOWEVER, USING IT APPROPRIATELY CAN REDUCE INJURY AND PREVENT DEATH.**

• This is an Enhanced Child Restraint System. It is approved according to UN Regulation No. 129, for use in compatible vehicle seating positions as indicated by vehicle manufacturers in the vehicle user manual. If in doubt, consult either the Enhanced Child Restraint System manufacturer or retailer.

• Please read the user instructions carefully before you use the Copernico for the first time. Always keep the manual in the storage compartment at the back area of the seat, so you always have it at hand whenever you need it.

The instructions must be kept with the child car seat if the latter is passed on to a third party.

• **IMPORTANT:** This Child Restraint System has been approved under Regulation UN ECE R129/03 for children of between 40 cm and 145 cm in height.

## USE CATEGORY

CLASS	HEIGHT GROUP	WEIGHT	AGE	INSTALLATION DIRECTION	RESTRAINT SYSTEM	INSTALLATION WAY	WAY OF USE
SPECIFIC VEHICLE ISOFIX	40-105 CM	≤ 18.5 KG	0-4 Y	REARWARD FACING	WITH INTEGRATED 5-POINT HARNESS	ISOFIX CONNECTORS + STAND	VEHICLE APPLICATION LIST
i-SIZE UNIVERSAL ISOFIX	76-105 CM		> 15 M - 4 Y	FORWARD FACING			
SPECIFIC VEHICLE BOOSTER SEAT	100-145 CM	/	4 Y - 12 Y	FORWARD FACING	WITH THE VEHICLE'S 3-POINT BELTS	CAR BELTS OR CAR BELTS + ISOFIX CONNECTORS  NO STAND	VEHICLE APPLICATION LIST

- **WARNING!** The Copernico child car seat can be installed:
  - **REARWARD FACING** for children with height ranging between 40 and 105 cm.
  - **FORWARD FACING** for children with height ranging between 76 and 145 cm.
- **IMPORTANT - DO NOT USE FORWARD FACING BEFORE THE CHILD'S AGE EXCEEDS 15 MONTHS.**
- The rearward facing position ensures top safety of the child inside the car. It is recommended to use the rearward facing position for the child seat even after 15 months of age.
- Consult a Doctor before using this product with babies with medical conditions.
- When the Copernico seat is used as i-Size Universal ISOFIX (see table), it can be installed on i-Size compatible seats, as indicated by the vehicle manufacturer in the relevant manual. For other uses please refer to the Vehicle Application List.
- If your vehicle does not have an i-Size seating position, the installation is allowed also on ISOFIX vehicle seats that are listed in the enclosed vehicle type list or check the latest version at [inglesina.com](http://inglesina.com).
- Always check before buying the product whether it can be properly installed in your vehicle. If in doubt, consult either

the child car seat manufacturer or the retailer.

- Please read and make sure you understand the car's instruction manual with regard to how to use child restraint systems.

During use, be sure to observe any restrictions relating to airbags.

- Do not use the Inglesina Copernico child car seat if:
  - it was subject to an accident, even to a slight one. It may have been subject to invisible damages. The product has to be replaced with a new one to assure the original safety level.
  - it is damaged, not equipped with the instruction manual, or any component is missing. Contact the Inglesina authorized Retailer or Customer Care Service immediately.
- Inglesina advises that child car seats should not be bought second-hand. They may have invisible damages that affect the safety performances.
- Verify the correct hooking of all components of the Copernico child car seat before each travel and/or when the vehicle is subject to periodical checks, maintenance, and cleaning. Other people may have moved and/or unhooked the Copernico child car seat and may not have repositioned it properly pursuant to the instructions.
- The temperature inside the parked vehicle can increase very quickly up to dangerous thresholds for the child, especially in summer. It is recommended to never leave your child unattended in the vehicle even for a few minutes.

## SAFETY BELTS

- **WARNING!** Always secure the child with the safety straps provided when the height of the baby is between 40 cm and 105 cm.
- Adjust the backrest position in accordance with the height of the child so that the back straps are behind the shoulders.
- Check that any straps restraining the child is adjusted to the child's body and is not twisted.
- Avoid putting thick clothes on your child under the belt.
- Make sure you can fit no more than one finger between the harness and your child (1 cm).
- The child's clothing should not interfere with the proper hooking of the buckle.
- Never leave the child in the child car seat if straps are loose or unfastened.
- When the child car seat is installed with the vehicle 3-points belt, make sure the lap strap is worn low down so that the pelvis is firmly engaged.

**• THE CHILD RESTRAINT SYSTEM MUST BE INSTALLED IN STRICT COMPLIANCE WITH THE INSTRUCTIONS PROVIDED. FAILURE TO OBSERVE INSTRUCTIONS/WARNINGS CAN SERIOUSLY COMPROMISE YOUR CHILD'S SAFETY.**

- Before assembling, verify that the product and all its components have not been subject to damages during transport. Should this be the case, do not use the product and keep it out of reach of children.
- For the safety of your child, remove and eliminate all plastic bags and elements belonging to the packaging before use and, in any case, keep them out of reach of newborns and children.
- Do not use the product, unless all its components are properly fastened and adjusted.
- Do not use the product if any components are broken or missing.
- Assembly, disassembly and adjustment operations must be carried out only by adults. Make sure that the person using the product (baby-sitter, grandparents, etc.) are aware of its correct operation.
- Do not insert your fingers inside the mechanisms.
- Do not use adapters other than those supplied with the product or in any case non approved by the Manufacturer.
- Remove the adapter when the child is more than 60 cm tall.
- Check if there are any special requirements related to the use of child restraint systems in the law in force in the country you are in.
- Do not make any alterations or additions to the child car seat without the approval of the Type Approval Authority. Unauthorized technical changes can cause the protective function of the child car seat to be reduced or completely eliminated.
- The homologation will be invalidated if you make any modifications to the product.
- Do not remove the adhesive and sewn labels. The removal of these labels could result in the product not complying with the law.
- Never use the child car seat without the lining and the shoulder pads. They cannot be replaced with others unapproved by the manufacturer as they are an integral part of the child restraint system and are essential for safety purposes.
- Do not use the child car seat in positions or configurations other than those illustrated in this user manual.
- Do not install it in rearward-facing vehicle seats or in vehicle seats that are transversal with respect to the direction of travel.



- **HAZARD!** Do not use Copernico child car seat, when used in rearward facing position, in vehicle seats where an active frontal airbag is installed. The front airbag explosive deployment may cause your child serious injury or even death.



- For vehicle seats with side airbags, please observe the instructions in your vehicle's manual.

- Make sure that the vehicle reclining seats are blocked in vertical position pursuant to the instruction of the car's manufacturer.
- Privilege installation on rear seats.
- **CAUTION!** Airbag activation too close may result in serious potential risks to the health of the child.
- **ATTENTION:** in some countries, the law in force prohibits child car seats from being installed in front seats. Check the law in force in the country where the device is being used.
- When installing the child car seat in forward facing position on vehicle's rear seats, it is advisable to move the front seat of the vehicle as far forward as possible.
- Check that rigid items and plastic parts of the child car seat are located and installed so that they are not liable, during

everyday use of the vehicle, to become trapped by a movable seat or in a door of the vehicle.

- During your journey, refrain from leaving unattended objects or bags in the car: make sure that they are stored securely as, in the event of an accident, they can cause injury.
- Check that the child car seat is correctly attached and make sure that your child is properly secured. Teach your child about the dangers involved.
- Always keep the child car seat hooked to the vehicle seat, even when the child car seat is empty. If you have to perform an emergency stop or if you are involved in a minor collision, an unsecured seat can injure you and other passengers.
- During your journey, all car occupants must be secured in compliance with the law in force in the country of use: in case of accident, they may unintentionally injure the child, even if the child car seat is used properly.
- Safe and appropriate driving behaviour is recommended: the child car seat is an effective restraint system but is not, on its own, sufficient to avoid severe injury in the event of a violent car crash. Please bear in mind that accidents, even those which occur at low speed, can be extremely dangerous for all car passengers.
- Never remove the child from the child car seat when the vehicle is moving; in case of need, stop as soon as possible in a safe place.
- When travelling, never hold your child in your arms or allow him to sit outside the child car seat.
- The driver should avoid any adjustment of the child car seat while travelling. In case of need, stop as soon as possible in a safe place.
- Never leave your child unattended in the vehicle.
- When getting out of the car, even for a short time, ensure that you always take your child with you.
- Pay attention to other moving vehicles when placing the child in the car seat.
- Only allow your child to enter and exit the vehicle on the pavement side.
- When vehicle is fully occupied lighter passengers should sit in the rear and heavier ones in the front.
- Car interiors can become very hot if the vehicle is left in direct sunlight. Cover the child car seat with a towel when it is not in use to prevent its components from overheating and cause injuries to the delicate skin of your child.
- During long journeys take frequent breaks as the child will tire easily.
- Always make sure that the temperature inside the passenger compartment is comfortable for the child. The use of sun shades is recommended in summer.
- This child car seat is designed only for short naps.
- Make sure all passengers are informed about how to release your child in case of emergency.

- Inglesina Baby S.p.A. guarantees that every article has been designed and manufactured in compliance with the general product quality and safety standards/regulations in force in the European Union and the countries it is marketed in.
- Inglesina Baby S.p.A. guarantees that during and after the manufacturing process, every product has undergone various quality controls. Inglesina Baby S.p.A. guarantees that, at the time of purchase from the Authorised retailer, every product had no installation or manufacturing defects.
- This warranty does not invalidate the rights acknowledged to the consumer by the applicable national legislation, which may vary depending on the country in which the product was purchased and the provisions of which, in the event of a contrast, prevail over the contents of the warranty herein.
- In the event of material or manufacturing defects detected at the time of purchase or during normal use, as described in the relevant instruction manual, Inglesina Baby S.p.A. grants a consecutive 24-month warranty from the date of purchase.
- The warranty is only valid in the country where the product was purchased and if it was purchased from an Authorised Retailer.
- The warranty acknowledged is valid for the first owner of the product purchased.
- The warranty covers the replacement or repair free of charge of parts with factory defects. Inglesina Baby S.p.A. reserves the right to decide at its sole discretion whether to apply the warranty via the repair or the replacement of the product.
- To apply the warranty, the product serial number needs to be presented, along with a copy of the receipt issued at the time of purchase of the product, making sure that the date of purchase is indicated in a clearly legible form.
- This warranty will be automatically made null and void in the event that:
  - the product is used for purposes that are not expressly indicated in the relevant instruction manual.
  - the product is not used in compliance with the relevant instruction manual.
  - the product has been repaired by unauthorised and unaffiliated Customer Care centres.
  - the structural or textile part of the product has been modified and/or tampered with, without prior expressed authorisation by the manufacturer. Any modifications made to the products relieve Inglesina Baby S.p.A. from any liability.
  - the defect is due to negligent or careless use (e.g., violent shocks to the structural parts, exposure to aggressive chemical substances, etc.).
  - the product presents normal wear (e.g., wheels, moving parts, fabrics) due to prolonged and continuous use.
  - the product has been damaged, even accidentally, by the owner himself/herself or by third parties (for instance when



it has been sent as luggage in air freight or using other means).

- the product is sent to the retailer for assistance without the original receipt and/or without the serial number or when the date of purchase on the receipt and/or the serial number are not clearly legible.
- Any damage caused by the use of accessories not supplied and/or not approved by Inglesina Baby, shall not be covered by the warranty.
- Inglesina Baby S.p.A. shall not be held liable for any damage to property or injuries to persons resulting from the improper and/or misuse of the product.
- After the warranty period has expired, the Company guarantees customer care service for consideration for its products for a maximum period of four (4) years from the date said products were placed on the market; after this period, assistance interventions will be assessed case by case.

### SPARE PARTS / AFTER SALES SERVICES

- Regularly inspect the safety devices to ensure the product's functionality over time. Do not use the product in the event of any malfunction and/or anomaly. Promptly contact your Authorised Retailer or the Inglesina Customer Care service.
- Do not use spare parts or accessories not supplied and/or not approved by Inglesina Baby S.p.A..

### WHAT TO DO IF YOU REQUIRE ASSISTANCE

- If you require assistance for your product, immediately contact the Inglesina Retailer that sold it to you, with the "Serial Number" relative to said object ready on hand.
- It is the Retailer's duty to contact Inglesina to assess the best suited intervention case by case and then provide the subsequent indications.
- The Inglesina Customer Care Service can provide any information, following written request by filling out the form provided on the website: [inglesina.com](http://inglesina.com) - Warranty and Assistance section.

### HINTS FOR CLEANING AND MAINTAINING THE PRODUCT

- The child car seats could leave traces on the vehicle seats, due to the measures taken to install it firmly in compliance with safety standards. This product was designed to minimize this effect as much as possible. The manufacturer cannot be considered liable for eventual traces deriving from normal use of the child car seat.

- Never force any mechanisms or moving parts; in case of doubt, check the instruction first.
- Store the product in a dry place.
- Protect the product against weather agents, water, rain or snow; moreover, continuous and prolonged exposure to sunlight can cause changes in the colour of many materials.
- Clean the plastic and metal parts with a damp cloth or with a mild detergent; do not use solvents, ammonia or benzene.
- Carefully dry metal parts after any contact with water to prevent the formation of rust.

### HINTS FOR CLEANING THE TEXTILE LINING

- It is recommended to wash the lining separately from other items.
- Periodically revive the fabric parts using a soft clothes brush.
- Observe the instructions for washing the textile lining given on the dedicated labels.



Handwash in cold water



Do not iron



Do not bleach



Do not dry clean



Do not tumble dry

Do not spin-dry



Dry flat in shade

- Dry the textile lining completely before using or storing it.
- **CAUTION!** Never wash the straps and buckle; just wipe them with a damp cloth.
- It is vital for the safety of your child that the harness buckle works correctly. Malfunctions of the harness buckle may be caused by accumulations of food, dirt or foreign bodies.
- Never lubricate or oil the harness buckle.

## INSTRUCTIONS

### LIST OF COMPONENTS

EN

- 1 Headrest adjustment handle
- 2 Headrest
- 3 Side protection system
- 4 Insert
- 5 5-point Safety Harness
- 6 Harness adjustment button
- 7 Recline button
- 8 Rotation button
- 9 ISOFIX connector arms
- 10 ISOFIX release button
- 11 ISOFIX connector arms extension paddle lever
- 12 Support leg
- 13 Support leg adjustment button
- 14 Support leg buffer stop
- 15 Upper belt guide
- 16 Lower belt guide
- 17 Plastic ISOFIX guides
- 18 ISOFIX Storage protector
- 19 Adapter

### 1. INSTALLING THE CHILD SEAT

**To install the Copernico child restraint system follow the steps below:**

- 1a. Unfold the leg (12) until it is in the vertical position as shown.
- 1b. Move the button (11) to slide the ISOFIX (9) backwards unfolding the connector fully. Do this for both connectors.
- 1c. Guide the connectors towards the ISOFIX anchors in your vehicle until they lock together by clicking into place and the indicator changes from red to green on both sides of the base.

**1d.** Move the seat backwards pressing the backrest against the vehicle seat. Then pull the safety seat towards you to check that it is securely locked in place.

**1e.** Press the button (13) to adjust the height of the support leg (12) until it is firmly in contact with the floor. It should not be on top of any type of compartment. At this point make sure that the support leg is at 90° to the safety seat. The visual ISOFIX indicators show whether the connector is open or closed. It may be that the connector is closed but not locked into the ISOFIX anchor. Please check that all the connectors are correctly locked into the vehicle anchor points by pulling the seat once it is installed.

**To detach the seat follow the same steps in reverse.**

**1f.** Move the button (10) to open the connector and release it from the anchor point.

## 2. USING THE COPERNICO IN THE REAR FACING OR FORWARD FACING POSITION

### **Installing the seat in the rear facing position, from 40 cm 105 cm**

**2a.** Press the button (8) and turn the seat.

**2b.** Turn the seat until it locks into the loading position ready for the child to be placed in it (perpendicular to the forward facing position).

**2c.** Press the button (8) again to place the seat in the rear facing position. It is important to check that the seat is firmly locked into place.

**Make sure the seat is fully reclined before rotating to rear facing position.**

**WARNING! Never use on a vehicle seat fitted with an AIRBAG.**

### **Installing the seat in the forward facing position, from 76 cm to 105 cm**

**2a.** Press the button (8) and turn the seat.

**2b.** Turn the seat until it locks into the loading position ready for the child to be placed in it (perpendicular to the forward facing position).

**2d.** Press the button (8) again to place the seat in the forward facing position. It is important to check that the seat is firmly locked into place.

## Installing the seat in the forward facing position, from 100 cm to 145 cm

### Storing the safety harness away

**2e.** Once the child has reached a height of 100 cm, the harness should be stored away and the child should be secured with the vehicle safety belt.

To store the harness away it needs to be fully loosen first, lift the cover and store the buckle parts in the compartment. Then put the cover back on the seat. Hiding the shoulder pad in the rear side of the upholstery.

**2f. IMPORTANT:** The support leg is not needed for the 100 - 145cm configuration, raise it so that it does not touch the floor of the vehicle.

**2g.** With the child placed in the seat put the vehicle seat belt on passing it through the guide (15). Fasten the vehicle seat belt buckle and make sure the belt is not too loose.

Gently pulling the diagonal part of the belt before placing the belt over the child's chest.

## 3. STRAPPING THE CHILD INTO THE SEAT

**This child restraint system has a loading position making it easy to place the child in the seat and adjust the straps to fit correctly.**

**3a.** Turn the seat to the loading position (2b) and open the harness (5). Move the harness straps to the sides to place the child in the seat.

**3b.** Place the straps over the child and fasten the buckle.

**3c.** To adjust the headrest (2) pull the lever (1) on the top. It should be set to the right position, this means that the shoulder harness should come out approximately 1 cm above the child's shoulders.

**3d.** Tighten the harness by pulling the strap (6), it should fit the child snugly.

**4a.** Once the child is securely strapped in, you can tilt the seat by pressing the lever (7) to the required position.

### Getting the child out of the seat

To get the child out of the seat, you should first place the seat in the loading position (2b).

**3e.** Loosen the harness straps by pressing the adjustment button.

**3a.** Then unfasten the buckle and get the child out.

Please make sure that the child gets out of the vehicle on the pavement side.

**WARNING! The straps should never be twisted.**

**The harness buckle must be fastened correctly and the straps should fit the child snugly.**

## 4. RECLINING INSTRUCTION

### **When use the seat in the rearward facing position, from 40-105 cm**

**4b.** The seat should be fully reclined before rotate to rearward facing, only the position 3 is allowed.

### **When use the seat in the forward facing position, from 76-135 cm**

**4c.** Once the child is securely strapped in, you can recline the seat by pressing the button (7) to the required position, all the 3 positions are allowed.

### **When use the seat in the forward facing position, from 126-145 cm**

**4d.** Only the position 1 is allowed.

## 5. USING THE ADAPTER

The insert cushion (19) is designed for use with new born babies to give them greater comfort and stability, and offer them a more stretched out position. The insert can be used until the baby is 60cm or until they outgrow it.